

# Erdgeschoss (EG)

- EG001
- EG002 CO<sub>2</sub>-Institut Schweiz
- EG003 Linnaeus University
- EG004 BFH Biel/Bienne
- EG005 TH Rosenheim
- EG006 Plant-for-the-Planet
- EG007 HBT-ISOL
- EG008 WEKA Media
- EG009 Sto.
- EG010 HELLA Sonnenschutztechnik
- EG011 LehmBau Sieberer
- EG012 Wipro
- EG013
- EG014
- EG015
- EG016 Timber Structures 3.0
- EG017 Remmers
- EG018 Treppenbau.ch
- EG019 Senova Kunststoffe
- EG020
- EG021
- EG022
- EG023
- EG024
- EG025
- EG026
- EG027
- EG028 CEMWOOD
- EG029 THERMO NATUR
- EG030 WOLF Bavaria
- EG031 Pfeiderer Deutschland
- EG032 Peikko Austria
- EG033 Josef Günthner
- EG034 INTHERMO
- EG035 Etex Building Performance
- EG036 Nordtreat AS
- EG037 Ludwig Künzel Nagelfabrik
- EG038 DRW-Verlag Weinbrenner
- EG039 Contec Deutschland
- EG040 Coverit
- EG041 Grupo Gámiz
- EG042 Lehmholzbau und Naturbaustoffhandel

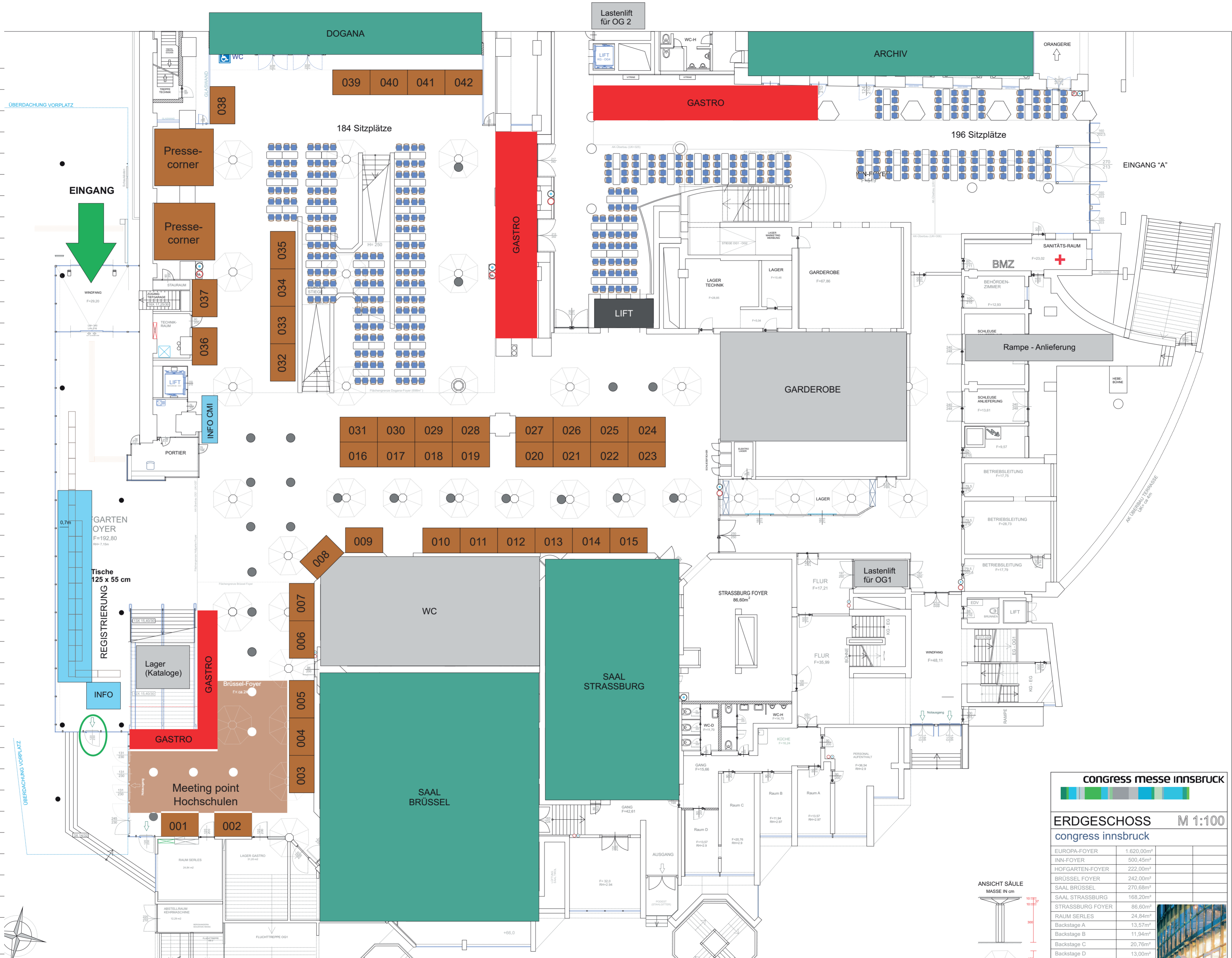

**congress messe innsbruck**

**ERDGESCHOSS M 1:100**  
congress innsbruck

EUROPA-FOYER	1.620,00m <sup>2</sup>
INN-FOYER	500,45m <sup>2</sup>
HÖFGARTEN-FOYER	222,00m <sup>2</sup>
BRÜSSEL FOYER	242,00m <sup>2</sup>
SAAL BRÜSSEL	270,68m <sup>2</sup>
SAAL STRASSBURG	168,20m <sup>2</sup>
STRASSBURG FOYER	86,60m <sup>2</sup>
RAUM SERLES	24,84m <sup>2</sup>
Backstage A	13,57m <sup>2</sup>
Backstage B	11,94m <sup>2</sup>
Backstage C	20,76m <sup>2</sup>
Backstage D	13,00m <sup>2</sup>

